

SEE SPECIAL
CONDITION(S)

March 31, 2021

Santee Cooper
Attn: Kevin Driggers
1 Riverwood Drive
Moncks Corner, SC 29461

Re: OCRM03103

91 7199 9991 7030 0138 5533

Dear Mr. Driggers:

The Office of Ocean and Coastal Resource Management (OCRM) is pleased to inform you that your permit application for the proposed project is complete and has been reviewed. The following information is provided for your information:

[REDACTED]

Sincerely,

Paul H. ...

[REDACTED]

cc: Mr. Blair Williams, Critical Area Permitting Section Manager

Guide to Board Review

Pursuant to S.C. Code Ann. § 44-1-60

The decision of the South Carolina Department of Health and Environmental Control (Department) becomes the final agency decision fifteen (15) calendar days after notice of the decision has been mailed to the applicant.

respond to the Clerk's email within forty-eight (48) hours and will request further review. If no Board member requests further review of the RFR within the forty-eight (48) hour period, the Clerk will send a letter by certified mail to the Requestor, with copy by regular mail to the applicant, permittee, or licensee, if not the Requestor, stating the Board will not hold a Final Review Conference. Contested case evidence will be included in the letter.

[REDACTED]

SOUTH CAROLINA DEPARTMENT OF HEALTH AND ENVIRONMENTAL CONTROL
OFFICE OF OCEAN AND COASTAL RESOURCE MANAGEMENT

CRITICAL AREA PERMIT & COASTAL ZONE CONSISTENCY CERTIFICATION

Permittee(s): Santee Cooper

Permit Number(s): OCRM03103

Date of Issuance: May 7, 2021

SEE SPECIAL

Location: On and adjacent to Pennys Creek at Johns Island substation approx 2.12 miles paralleling the existing Santee Cooper Mateeba-Johns Island transmission ROW, Johns Island, Charleston County, South Carolina

This permit is issued under the provisions of S. C. Code Ann. Section 48-39-10, et seq., and 23A S.C. Code Ann. Regs. 30-1 through 30-18, as amended. Please carefully read the project description and special conditions that accompany this

PERMITTEE'S ATTENTION IS DIRECTED TO GENERAL CONDITIONS NUMBERS FOUR (4) AND FIVE (5). BY ACCEPTANCE OF THIS PERMIT, PERMITTEE IS PLACED ON NOTICE THAT THE STATE OF SOUTH CAROLINA, BY ISSUING THIS PERMIT, DOES NOT

~~WAIVE ITS RIGHT TO REQUIRE PAYMENT OF A REASONABLE FEE FOR THIS PERMIT.~~
[REDACTED]

Your signature below, as permittee indicates that you accept and agree to comply with the terms and conditions of this permit.

PERMITTEE(S)

DATE

5-27-21

[REDACTED]

This permit becomes effective when the State official designated to act for the Office of Ocean and Coastal Resource

CRITICAL AREA PERMITTING PROJECT MANAGER

DATE

5-7-21

Joshua D. Hoke
[REDACTED]

SEE SPECIAL
CONDITION(S)

GENERAL CONDITIONS:

**SEE SPECIAL
CONDIT ON(S)**

1. The permittee in accepting this permit covenants and agrees to comply with and abide by the provisions and

notified that the Department intends to revoke the permit, Permittee agrees to immediately stop work pending resolution of the revocation.

[REDACTED]

OFFICIAL

SAVANNAH H

LON

526

EXISTING DOMINION
CHURCH CRFFK -

BI

US MAIL

N E



1

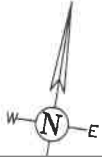

TRUE

**PROPOSED JOHNS ISLAND -
QUEENSBORO 115kV ROUTE
CENTERLINE STARTING POINT**

**JOHNS ISLAND 230-115kV
ELECTRICAL SUBSTATION**

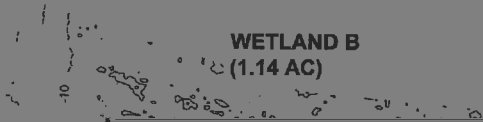

**WETLAND B
(1.14 AC)**

**PROPOSED POLE
LOCATION (typ.)**

EXISTING SANTEE

**WETLAND D
(1.15 AC)**

**WETLAND A
(0.27 AC)**

**PROPOSED
NEW SANTEE
COOPER ROW**

E

TRUE

TMS #
(typ.)

EXISTING SANTEE
COOPER ROW

WETLAND E
(1.19 AC)

FIGGING HILL RD

WETLAND G
(0.03 AC)

PROPOSED
NEW SANTEE
COOPER ROW

PROPOSED
JOHNSTON ISLAND
- QUEENSBORO
HORY ROUTE

(0.41 E, 0.02 AC)

WETLAND F
(0.17 AC)

INSET 1
INSET 2

SEE SPECIAL

250

GRAPHIC SCALE IN FEET
SCALE: 1" = 500'

Latitude: 42.75064° N
Longitude: -80.05623° W

PREPARED
BY: BWS

DATE:
09/17/20

CHECKED
BY: AWC

JOB NUMBER:
6250-16-0115.06

N E

EXISTING SANTEE
COOPER ROW

CRITICAL
AREA LINE
(typ.)

OLD POND ROAD



TMS #
(typ.)

WETLAND I
(0.37 AC)

WETLAND K

WETLAND H
(0.22 AC)

ROW

STREAM
(1,183 LF,

- QUEENSBORO

LRD

SFF SDE1



BROWNSWOOD ROAD

5

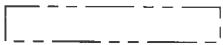

PROP
JOHNS
-QU N.
V ROI
ENTER

INSET 6
INSET



PREPARED
BY: BWS

DATE:
09/17/20

CHECKED
BY: AWC

JOB NUMBER:
6250-16-0115.06

FIGURE:
7

TRUE

N
E

NSI
INSE

EBB

WETLAND

SEE SPECIAL
CONDITIONS

RUSHLAND MEWS

MURRA

PREPARED
BY: BWS

DATE:
09/17/20

CHECKED
BY: AWC

JOB NUMBER:
6250-16-0115.06

13 of 17

NOTE:

1. DISTANCE LEADERS INDICATE EITHER THE DISTANCE BETWEEN PROPOSED POLE LOCATION AND EDGE OF CRITICAL AREA OR TO NEAREST ROAD IF THE CRITICAL AREA IS LOCATED OUTSIDE THE PROJECT STUDY AREA.
2. MINIMUM CLEARANCE ABOVE ALL HIGH WATER MARKS WILL BE 30-FEET.

N E

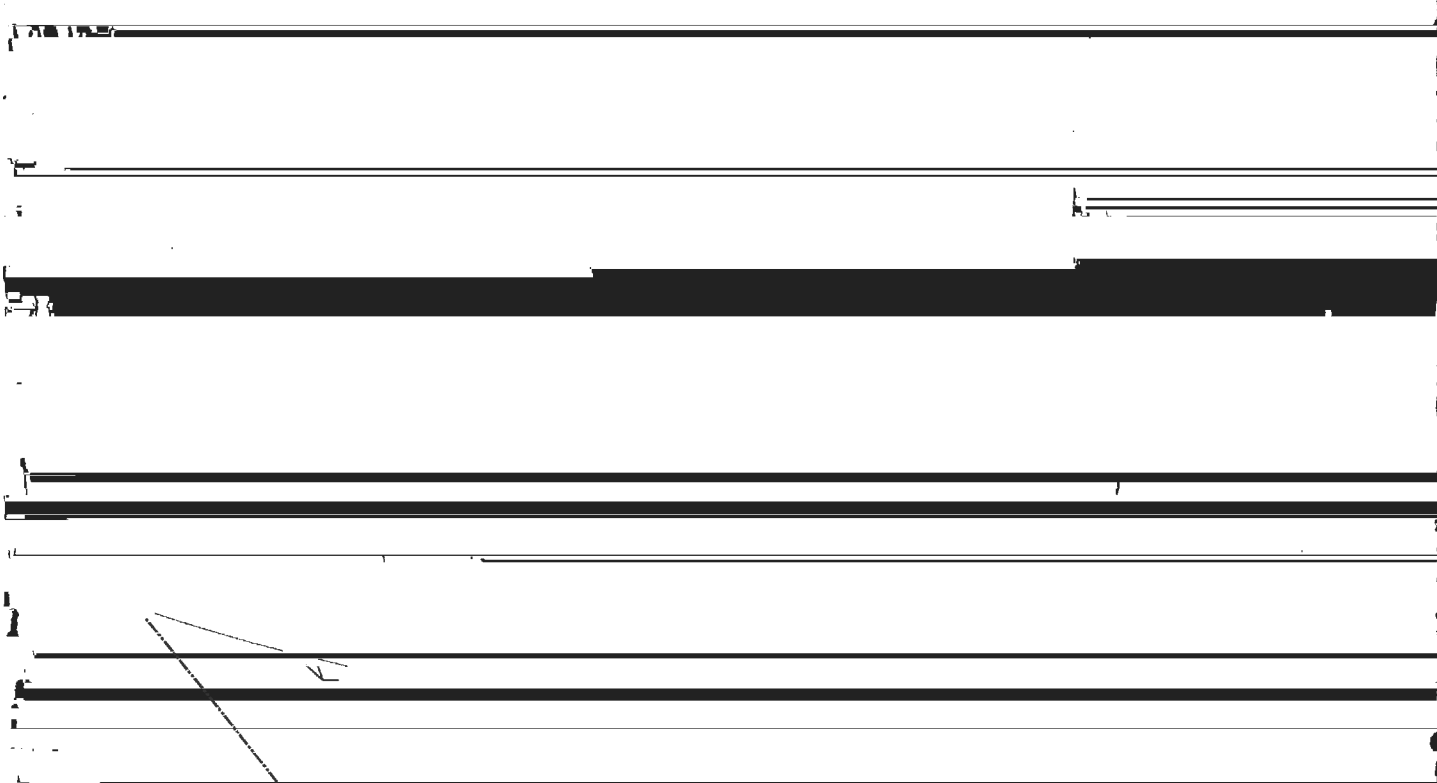

SAME ELEVATION OR HIGHER THAN THE EXISTING DOMINION CHURCH CREEK - QUEENSBORO TRANSMISSION LINE.

**OPEN WATER 2, TIDAL
(PENNY'S CREEK, 0.19 AC)**

**TMS #
(typ.)**

**PROPOSED POLE
LOCATION (typ.)**
POLE 47 POLE

**EXISTING
DOMINION
ROW**

**EXISTING
CHURCH CREEK - THE COMMONS
QUEENSBORO DOMINION
TRANSMISSION LINE**

LEGEND

GRAPHIC SCALE IN FEET
SCALE: 1" = 500'

PROPOSED SANTEE
COOPER RIGHT-OF-WAY
DELINEATED AQUATIC
RESOURCE

EXISTING SANTEE
COOPER / DOMINION
RIGHT-OF-WAY

CRITICAL AREA LINE
POLE LOCATION

PROPERTY BOUNDARY
EXISTING MINOR CONTOUR
EXISTING MAJOR CONTOUR

(4.61 AC)

FLOOD

**DELINEATED
CRITICAL AREA
(typ.)**

**PROPOSED JOHNS ISLAND -
QUEENSBORO TRANSMISSION
CENTERLINE ENDING POINT.**

PREPARED
BY: BWS

DATE:
09/17/20

CHECKED
BY: AWC

JOB NUMBER:
6250-16-0115.06

ELEV.

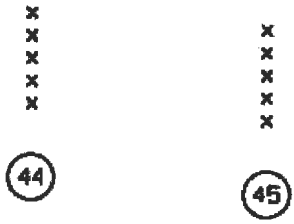

PLAN

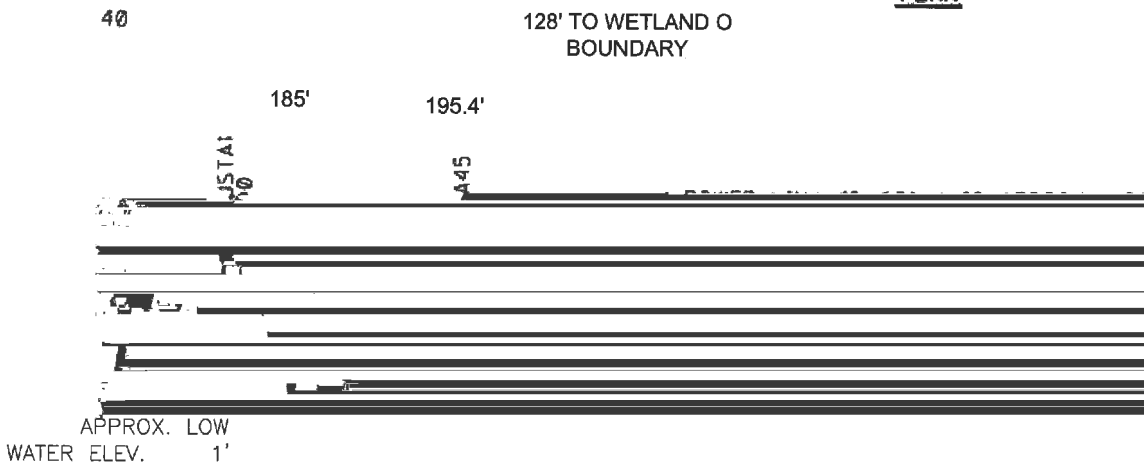

PROFILE VIEW OF PENNYS CREEK CROSSING
Santee Cooper Johns Island-Queensboro 115kV Line, Johns Island, SC
FOR



PREPARED
BY: BWS

DATE:
09/17/20

CHECKED
BY: AWC

JOB NUMBER:
6250-16-0115.06

FIGURE:
10

ELEV.



EBB
LOW

80

PLAN

40

731' TO WETLAND O
BOUNDARY

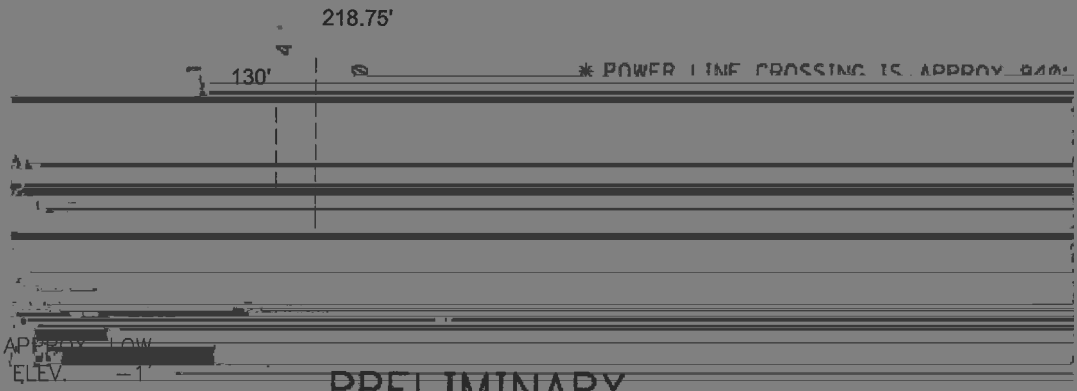

PRELIMINARY

NOTE: PROFILE DRAWING PROVIDED BY SANTEE COOPER. DATFD. APRIL 18, 2020 ARE PRELIMINARY AND SHOULD STRICTLY BE USED

SEE SPECIAL

PROFILE VIEW OF PENNYS CREEK CROSSING
Santee Cooper Johns Island-Queensboro 115kV Line, Johns Island, SC
FOR



PREPARED
BY: BWS

DATE:
09/17/20

CHECKED
BY: AWC

JOB NUMBER:
6250-16-0115.06

FIGURE:
11

16 of 17

